



Version #1.2
Sept 19th, 2019

12x8 Studio Garden Shed Interior Wall Kit Assembly Manual

Thank you for purchasing a 12x8 Studio Garden Shed Interior Wall Kit. Please take the time to identify all the parts prior to assembly.



Customer agrees to hold Outdoor Living Today and any Authorized Dealers free of any liability for improper installation, maintenance and repair.

In the event of a missing or broken piece, call the Outdoor Living Today Customer Support Line @ 1-888-658-1658 within 30 days of the delivery of your purchase. It is our commitment to you to courier replacement parts, free of charge, within 10 business days of this notification. Replacement parts will not be provided free of charge after the 30 day grace period.

All structures purchased from Outdoor Living Today are covered for a period of one year for defects in manufacturing and workmanship. Costs incurred for customer installations are not included.

Failure to use supplied parts included in this kit could result in poor product performance and may void your warranty. Please contact Outdoor Living Today's Customer Toll Free Line if you plan to deviate from our written instructions.

**Thank you for purchasing our 12x8 Studio Garden Shed Interior Wall.
Please take the time to identify all the parts prior to assembly.**

| | |
|--|---|
| 1. Ceiling Plywood Ceiling 1A: 1 - 3/8" thick x 47 3/4" x 92 1/2" Center Ceiling Panel 1B: 2 - 3/8" thick x 41 1/2" x 92 1/2" - Left/Right Ceiling Panel | Steps ↓ 1&2 |
| 2. Interior Wall Section Main Wall Panels 2A: 4 pcs - 1 1/2" x 2 1/2" x 30"l - Rear Wall Nailing Cleats ----- 2B: 2 pcs - 42 3/4"w x 44 1/2"h - Bottom Rear Wall Panels- Left/Right Side ----- 2C: 2 pcs - 42 3/4"w x 40 1/4"h - Top Rear Wall Panels- Left/Right Side ----- 2D: 1 - 45 1/4"w x 44 1/2"h - Bottom Center Wall Panel ----- 2E: 1 - 45 1/4"w x 40 1/4"h - Top Center Wall Panel ----- 2F: 2 pcs - 46 1/2"w x 78"h - Large Window Wall Panels - Left/Right Sides ----- 2G: 2 pcs - 46 1/2"w x 23 1/4"h - Transom Window Wall Panels - Left/Right Sides ----- 2H: 1 - 39 1/4"w x 22 1/4"h - Transom Window Wall Panel - Center ----- 2I: 2 pcs - 45 1/4"w x 44 1/2"h - Bottom Side Wall Panels- Left/Right Side- (front) ----- 2J: 2 pcs - 45 1/4"w x 57 5/8"h -Top Side Wall Panel- Left/Right - Angled (front) ----- 2K: 2 pcs - 44 7/8"w x 44 1/2"h - Bottom Side Wall Panels- Left/Right Side- (rear) ----- 2L: 2 pcs - 44 7/8"w x 49"h -Top Side Wall Panel- Left/Right - Angled (rear) ----- | Steps ↓ 3 4 & 6 5 & 7 8 9 10 & 11 12 & 13 14 15 16 17 18 & 19 |
| 3. Trim Section Large Window Sash 3A: 2 - 1/2" x 2 7/8" x 35 7/8" Straight Cut Top Sash (1/ window) ----- 3B: 4 - 5/8" x 2 7/8" x 35 3/8" Straight Cut Vertical Sash (2/ window)----- 3C: 2 - 5/8" x 3 3/8" x 29 1/8" Straight Cut Ledge (1/ window) ----- Transom Window Sash 3D: 6 - 1/2" x 2 7/8" x 35 1/4" Straight Cut Top/Bottom Sash (2/ window) ----- 3E: 6 - 1/2" x 2 7/8" x 9 1/4" Straight Cut Side Sash (2/ window) ----- Corner Trim - Moulded 3F: 2 - Rounded - 85 3/8" with 11 deg. one end - Rear Corner ----- 3G: 2 - Rounded - 70" Straight Cut- Front Corner ----- 3H: 2 - Rounded - 32" with 11 deg. one end - Front Corner ----- Horizontal Rear/Front/Side Trims - 3I: 2 - 1/4" x 1 1/2" x 45 1/2" -11 deg both end - Side Walls ----- 3J: 2 - 1/4" x 1 1/2" x 44 3/8" -11 deg both end - Side Walls ----- 3K: 4 - 1/4" x 1 1/2" x 64" - Straight Cut - Rear and Front Walls ----- Side/Rear Wall Vertical Trims - 3L: 2 - 1/4" x 1 1/2" x 60" -11 deg. one end Side Walls ----- 3M: 2 - 1/4" x 1 1/2" x 32" -Straight cut- Side Walls ----- 3N: 2 - 1/4" x 1 1/2" x 83 1/2" -Straight cut- Rear Walls ----- Door and Window Trims - 3O: 2 - 1/2" x 2 1/2" x 80 3/4" -45 deg. one end. Vertical Door Trims ----- 3P: 1 - 1/2" x 2 1/2" x 41" -45 deg. both ends. Horizontal Door Trim ----- 3Q: 4 - 1/2" x 1 1/2" x 36 7/8" 45 deg.1 end Vertical Large Window Trim (2/window) ----- 3R: 2 - 1/2" x 1 1/2" x 32 1/4" 45 deg both ends Top Hor. Large Window Trim (1/window)--- 3S: 4 - 1/2" x 1 1/2" x 37 1/2" -45 deg. both ends Top/Bottom Transom L/R (2/ window) --- 3T: 4 - 1/2" x 1 1/2" x 12 1/2" -45 deg. both ends Side Transom L/R (2/ window) ----- 3U: 2 - 1/2" x 1 1/2" x 34 1/2" -Straight cut ends Top/Bottom Transom-Center (2/ window) 3V: 2 - 1/2" x 3" x 20" -Straight cut ends Sides Transom-Center(2/ window) ----- Ceiling Trim 3W: 2 - 1/4" x 1 1/2" x 92 1/4" -Straight cut- Ceiling ----- Floor Base Trims - 3X: 9 - 1/4" x 1 1/2" x 48" -Straight cut- (customer to cut to length)----- | Steps ↓ 20-21 22-23 24 25 26 27 28 29 30 31 32 |

12X8 Studio Interior Wall Kit **HARDWARE PACKAGE**

Hardware Kit (Provided)

2 1/2"  x 15

1 1/2"  x 430
Finishing

1 1/4"  x 126

 x 1
Square Drive Bit

Tools Required (Not Provided)



Hammer



Screw Gun/Drill



Tape Measure



Level



Pliers

2
Ladders



1/8" Drill Bit

Safety Equipment Required (Not Provided)



Safety Glasses



Work Gloves

Optional Materials and Tools - Not Included in Kit

Materials to Insulate Shed prior to installing Interior Wall Kit

2" thick Foam Board Insulation
364 sq ft. (covers walls and ceiling)

96 sq ft additional for floor

6 mm Poly - Air Vapor Barrier -

Tools -

Staple Gun

Utility Knife

Caulking Gun and Caulking

Exploded view of all parts necessary to complete Interior Wall Section Ceiling and Panelized Walls.
Identify all parts prior to starting.

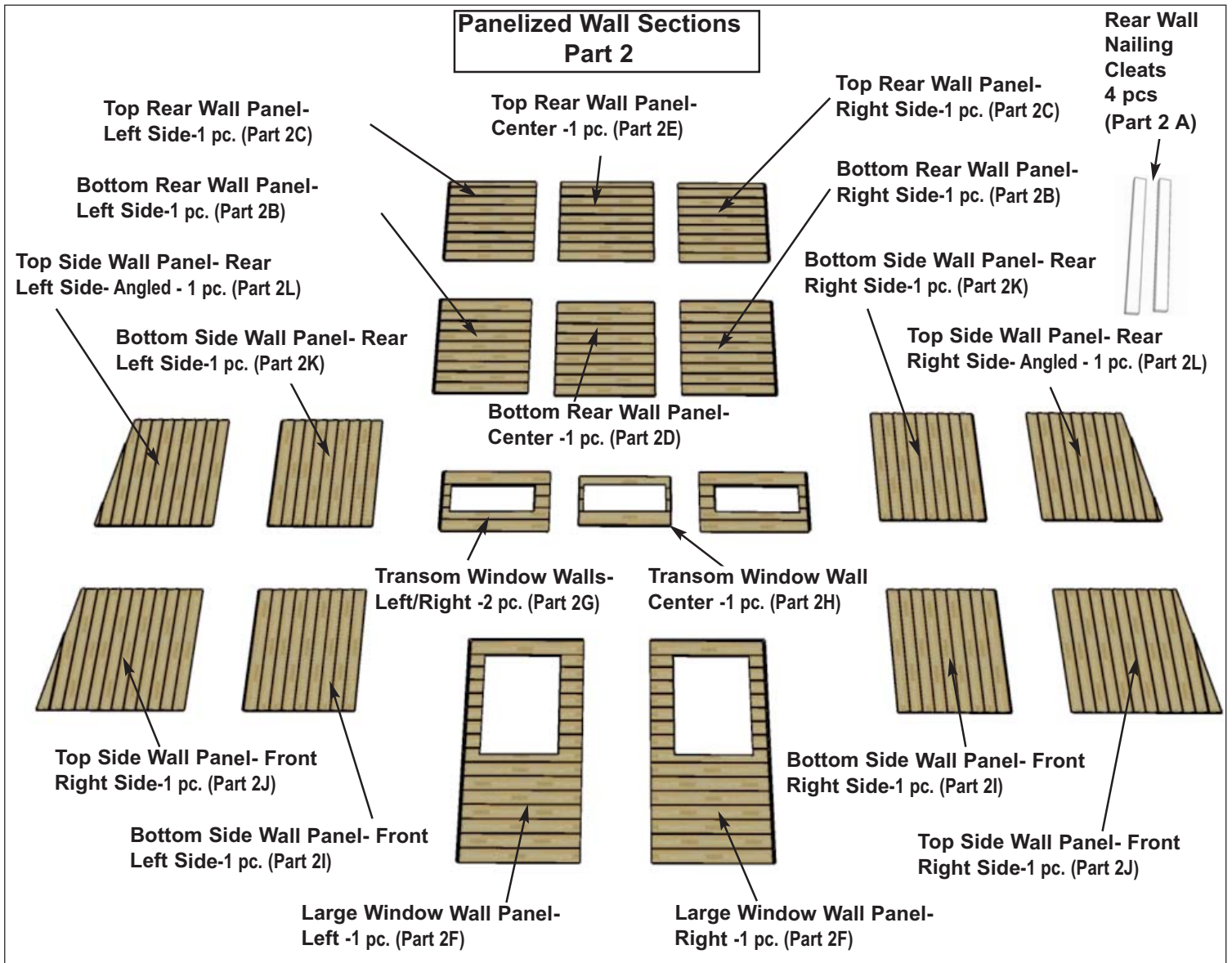
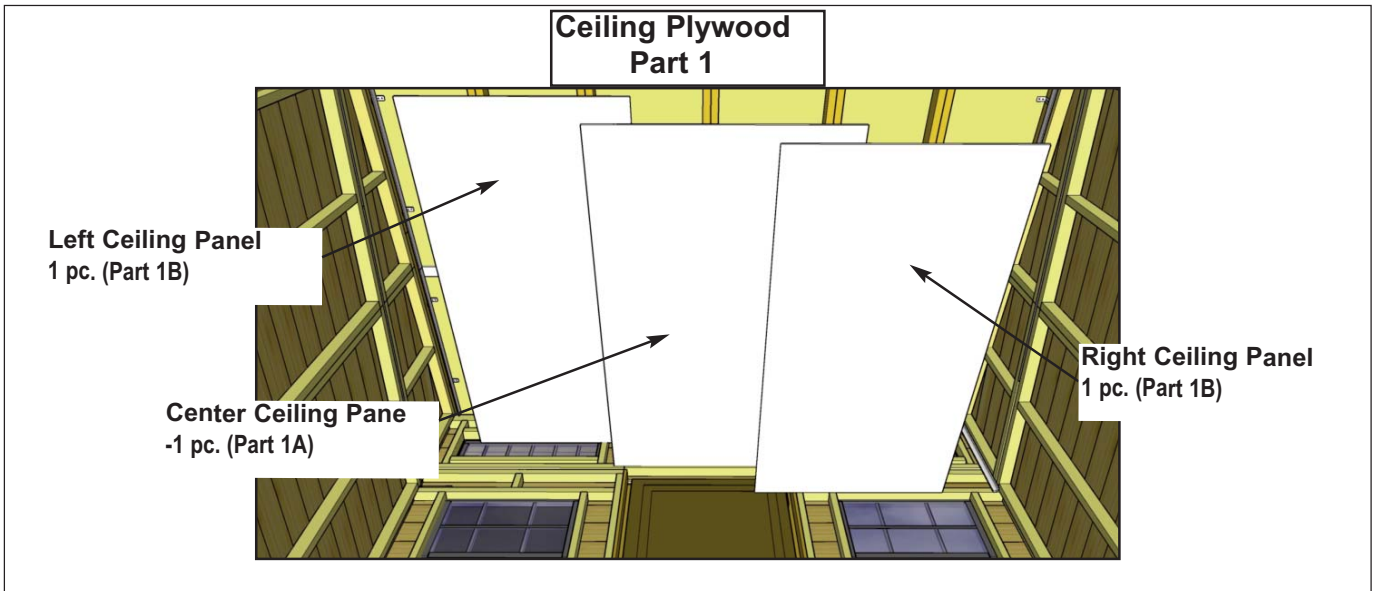

1. Ceiling Plywood Section

1. Lift Center Ceiling Panel up positioning evenly on center rafters. Attach with **10 - 1 1/4" Screws**. You can find the **Square Drive Screw Bit** in the Hardware Kit Bag.

Parts

1A - Center Ceiling Panel
(3/8" x 47 3/4" x 92 1/2") x 1

Hardware

S2 - 1 1/4" Screws x 10 total

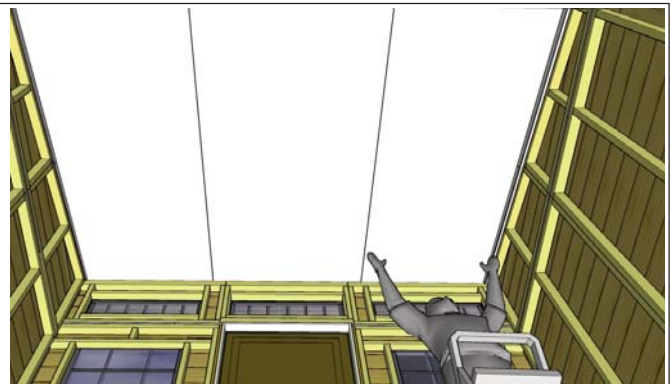

2. Lift Left/Right Ceiling Panels up positioning evenly on rafters and tight against center ceiling panel. Attach with **10 - 1 1/4" Screws** per panel.

Parts

1B - Left/Right Ceiling Panels
(3/8" x 41 1/2" x 92 1/2") x 2

Hardware

S2 - 1 1/4" Screws x 20 total

2. Wall Section



3. Position and attach Rear Wall Nailing Cleats in rear wall corners only. There are 2 cleats per corner. Evenly space. Attach with **3 - 2 1/2" Screws** per piece.

Parts
2A - Rear Wall Nailing Cleats (1 1/2" x 2 1/2" x 30") x 4

Hardware
S1 - 2 1/2" Screws x 12 total

4. Position and attach Bottom Rear Wall Panel against cleat. Plywood extends past siding on left side. Attach with **4 - 1 1/4" Screws** per piece. 1 screw per corner.

Parts
2B - Bottom Rear Wall Panel (42 3/4"w x 44 1/2"h) x 1

Hardware
S2 - 1 1/4" Screws x 4 total

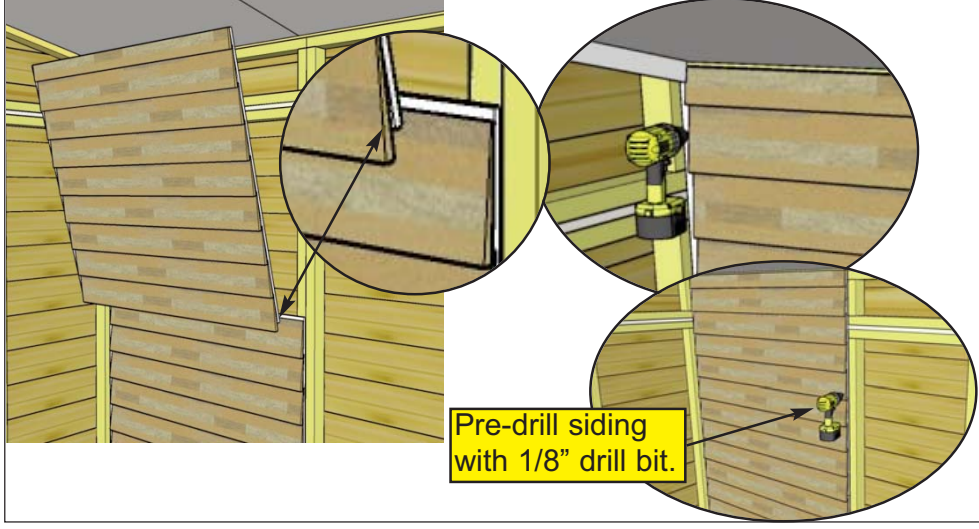
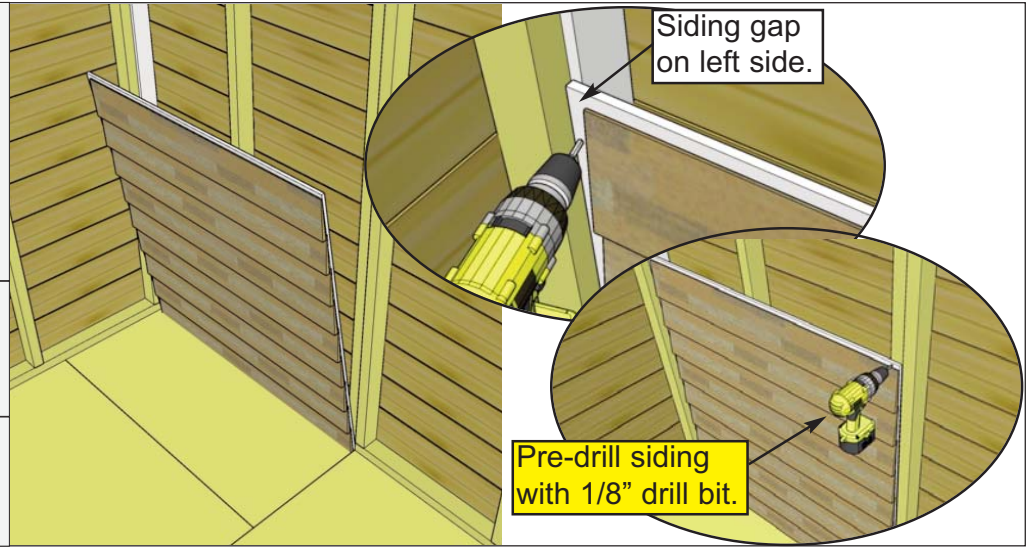

5. Position and attach Top Rear Wall Panel against cleat. Plywood extends past siding on left side. Attach with **4 - 1 1/4" Screws** per piece. 1 screw per corner.

Parts
2C - Top Rear Wall Panel (42 3/4"w x 40 1/4"h) x 1

Hardware
S2 - 1 1/4" Screws x 4 total

6. Position and attach Bottom Rear Wall Panel against cleat. Plywood extends past siding on right side. Attach with **4 - 1 1/4" Screws** per piece. 1 screw per corner.

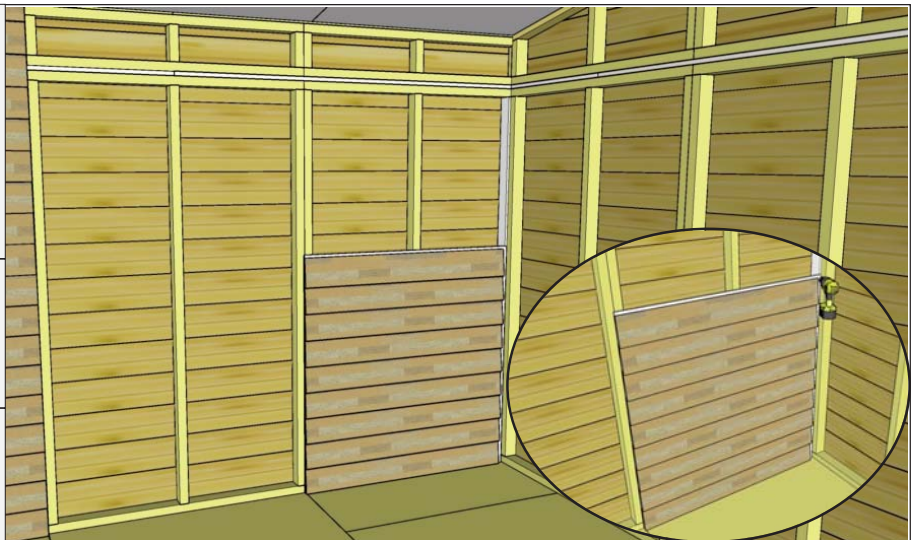

Parts

2B - Bottom Rear Wall Panel
(42 3/4"w x 44 1/2"h) x 1

Hardware

S2 - 1 1/4" Screws
x 4 total

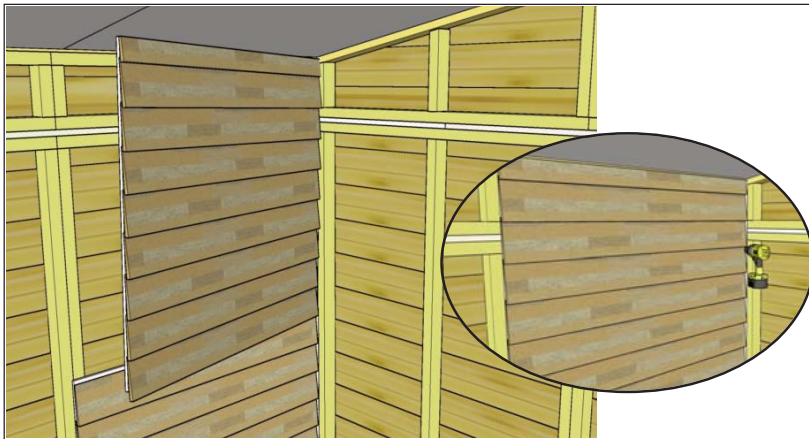

7. Position and attach Top Rear Wall Panel against cleat. Plywood extends past siding on right side. Attach with **4 - 1 1/4" Screws** per piece. 1 screw per corner.

Parts

2C - Top Rear Wall Panel
(42 3/4"w x 40 1/4"h) x 1

Hardware

S2 - 1 1/4" Screws
x 4 total

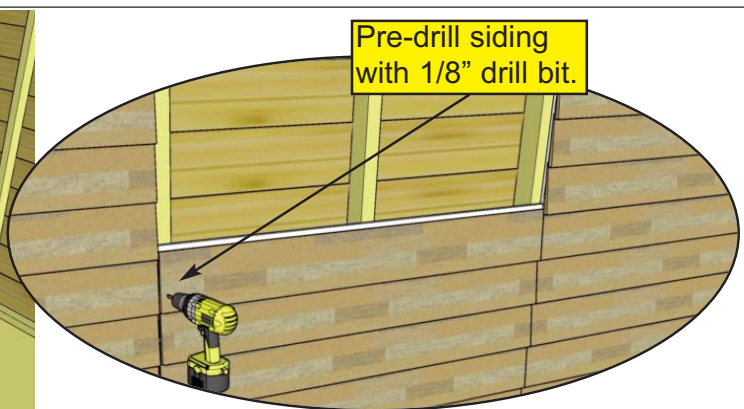
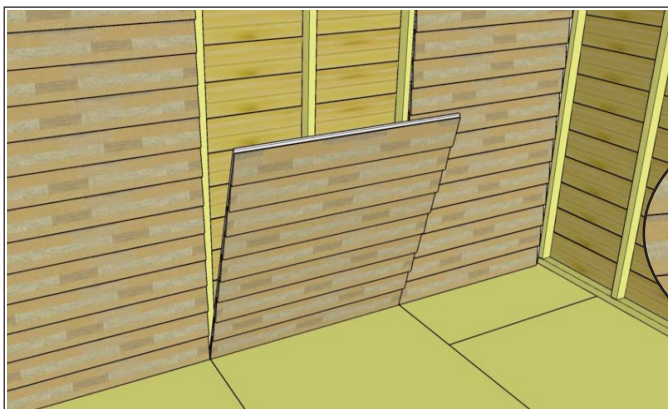

8. Position and attach Bottom Center Wall Panel against middle wall studs. Attach with **4 - 1 1/4" Screws** per piece. 1 screw per corner.

Parts

2D - Bottom Center Wall Panel
(45 1/4"w x 44 1/2"h) x 1

Hardware

S2 - 1 1/4" Screws
x 4 total

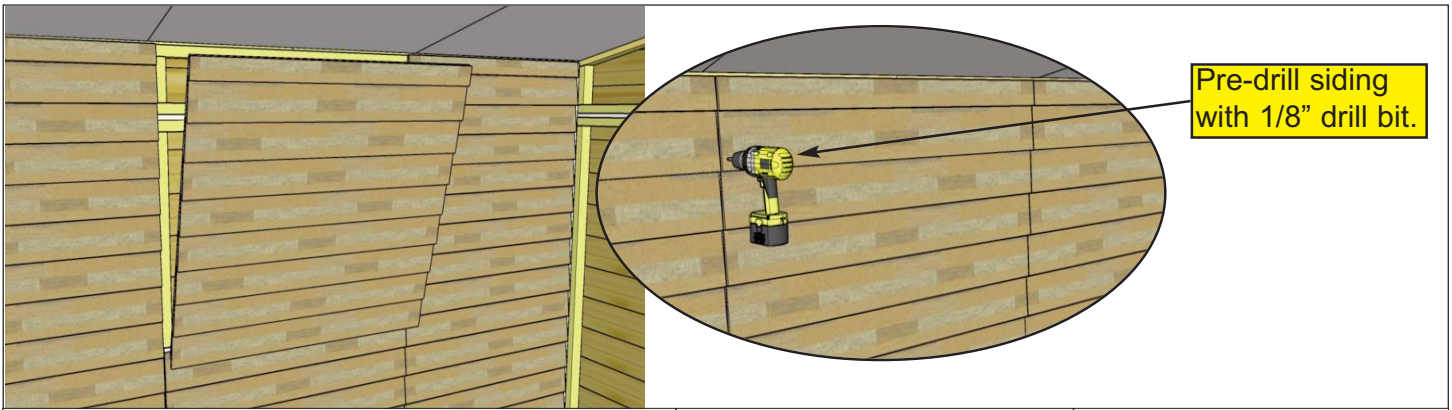

| | | |
|--|--|--|
| 9. Position and attach Top Center Wall Panel against middle wall studs. Attach with 4 - 1 1/4" Screws per piece. 1 screw per corner. | <u>Parts</u> | <u>Hardware</u> |
| | 2E - Top Center Wall Panel (45 1/4"w x 40 1/4"h) x 1 | S2 - 1 1/4" Screws x 4 total |



| | | |
|---|--|--|
| 10. Position and attach Large Window Wall Panel against wall studs in left corner. Plywood extends past siding on left side. Attach with 6 - 1 1/4" Screws per piece. | <u>Parts</u> | <u>Hardware</u> |
| | 2F - Large Window Wall Panel (46 1/2"w x 78"h) x 1 | S2 - 1 1/4" Screws x 6 total |



11. Position and attach Large Window Wall Panel against wall studs in right corner. Plywood extends past siding on right side. Attach with **6 - 1 1/4" Screws** per piece.

Parts
2F - Large Window Wall Panel
 (46 1/2"w x 78"h) x 1

Hardware
S2 - 1 1/4" Screws
 x 6 total

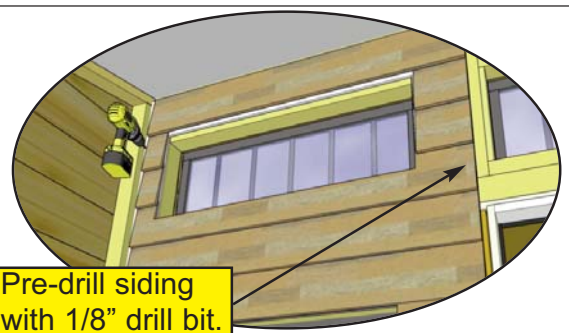
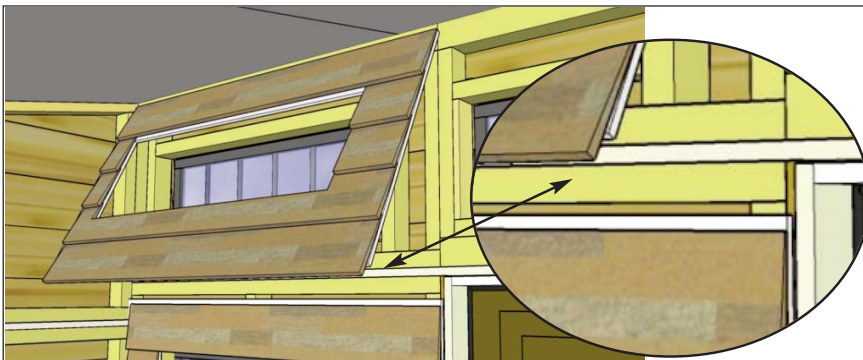

Pre-drill siding with 1/8" drill bit.

12. Position and attach Transom Window Wall Panel in left top corner. Plywood extends past siding on left side. Siding will overhang window wall siding on bottom. Attach with **4 - 1 1/4" Screws** per piece.

Parts
2G - Transom Window Wall Panel
 (46 1/2"w x 23 1/4"h) x 1

Hardware
S2 - 1 1/4" Screws x 4 total

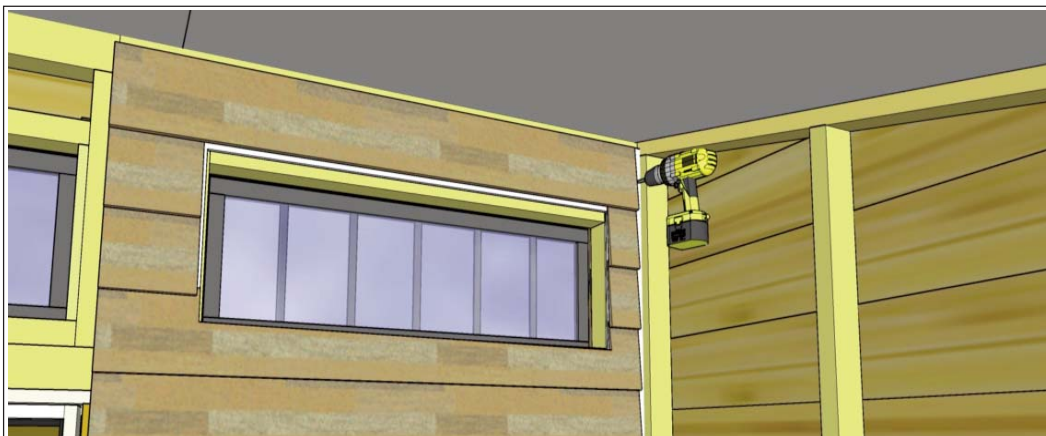

13. Position and attach Transom Window Wall Panel in right top corner. Plywood extends past siding on right side. Siding will overhang window wall siding on bottom. Attach with **4 - 1 1/4" Screws** per piece.

Parts
2G - Transom Window Wall Panel
 (46 1/2"w x 23 1/4"h) x 1

Hardware
S2 - 1 1/4" Screws x 4 total

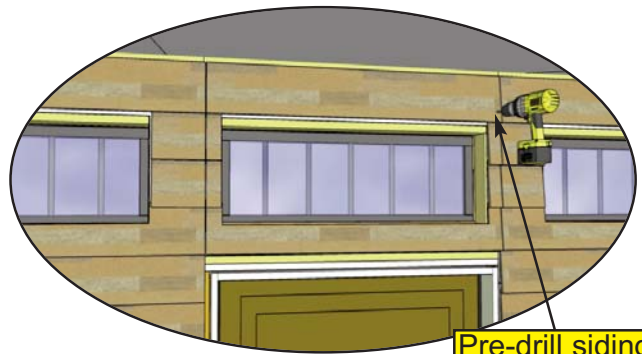

Pre-drill siding with 1/8" drill bit.

14. Position and attach Transom Window Wall Panel in center between left/right transom windows. Attach with **4 - 1 1/4" Screws** per piece.

Parts
2H - Transom Window Wall Panel - Center
 (39 1/4"w x 22 1/4"h) x 1

Hardware
S2 - 1 1/4" Screws
 x 4 total

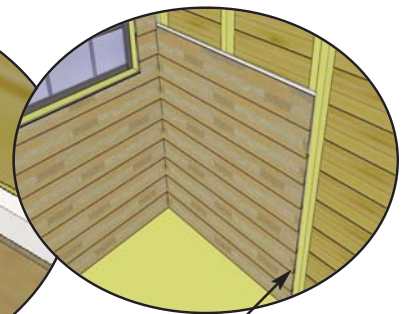
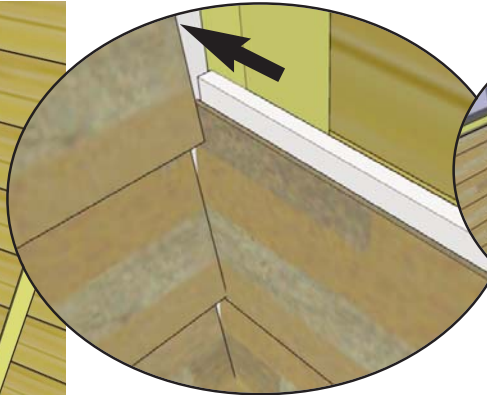
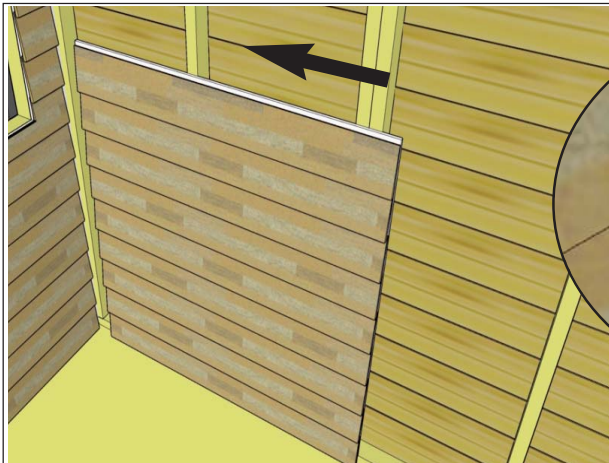

Pre-drill siding with 1/8" drill bit.

15. Position and attach Bottom Right Side Wall Panel in front corner. Panel will slide in between window panel in corner. Attach with **4 - 1 1/4" Screws** per piece.

Parts
2I - Bottom Right Side Wall Panel - Front
 (45 1/4"w x 44 1/2"h) x 1

Hardware
S2 - 1 1/4" Screws
 x 4 total

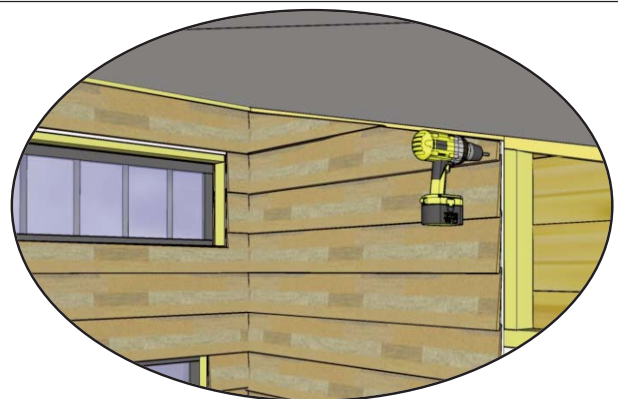

16. Position and attach Top Right Side Wall Panel Angled in front corner. Panel will slide in between window panel in front corner. Attach with **4 - 1 1/4" Screws** per piece.

Parts
2J - Top Right Side Wall Panel - Angle Front
 (45 1/4"w x 57 5/8"h) x 1

Hardware
S2 - 1 1/4" Screws
 x 4 total

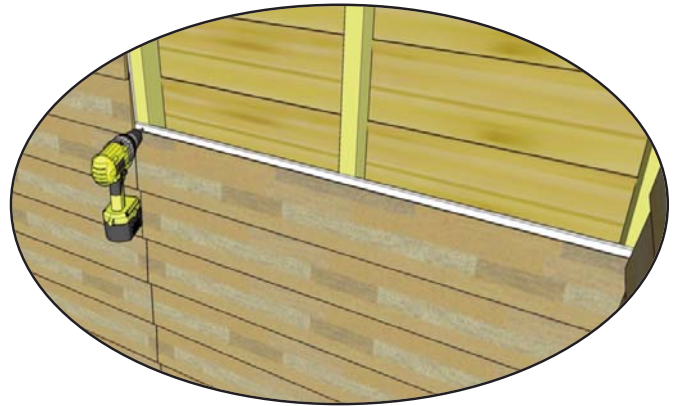
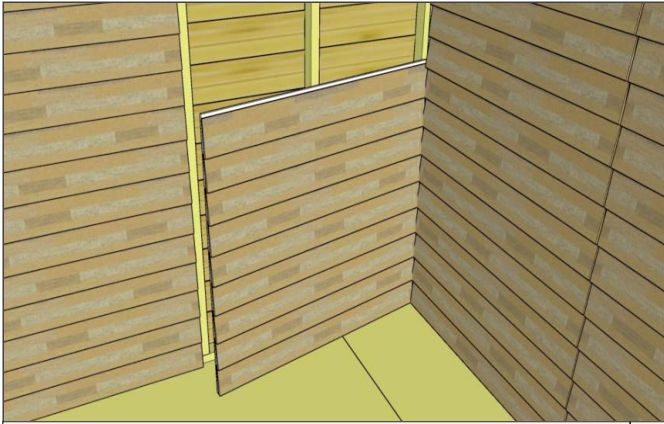

17. Position and attach Bottom Right Side Wall Panel in rear corner. Panel will slide in between window panel in corner. Attach with **4 - 1 1/4" Screws** per piece.

Parts
2K - Bottom Right Side Wall Panel - Rear
 (44 7/8" w x 44 1/2" h) x 1

Hardware
S2 - 1 1/4" Screws
 x 4 total

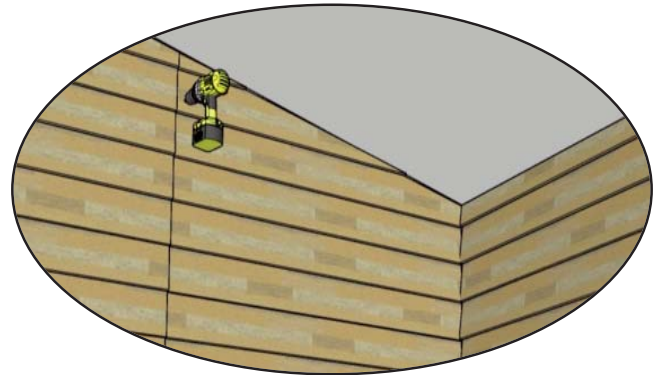
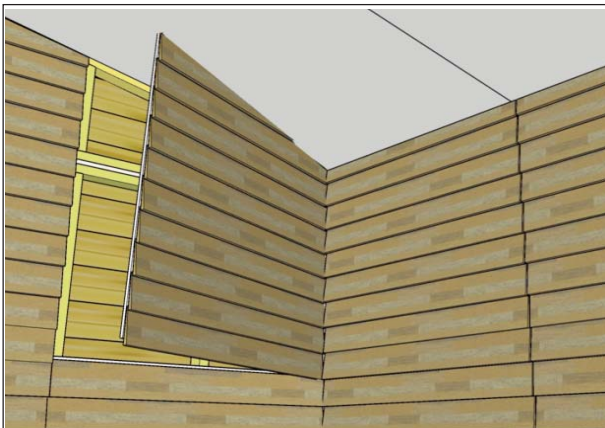

18. Position and attach Top Right Side Wall Panel Angled in rear corner. Panel will slide in between window panel in corner. Attach with **4 - 1 1/4" Screws** per piece.

Parts
2L - Top Right Side Wall Panel - Angle Rear
 (44 7/8" w x 49" h) x 1

Hardware
S2 - 1 1/4" Screws
 x 4 total



19. Complete Left Side Wall Panels following **Steps 15-18.**

Parts
2I - Bottom Left Side Wall Panel - Front
 (45 1/4" w x 44 1/2" h) x 1
2J - Top Left Side Wall Panel Angle - Front
 (45 1/4" w x 57 5/8" h) x 1
2K - Bottom Left Side Wall Panel - Rear
 (44 7/8" w x 44 1/2" h) x 1
2L - Top Left Side Wall Panel Angle - Rear
 (44 7/8" w x 49" h) x 1

Hardware
S2 - 1 1/4" Screws x 16 total

3. Trim Section

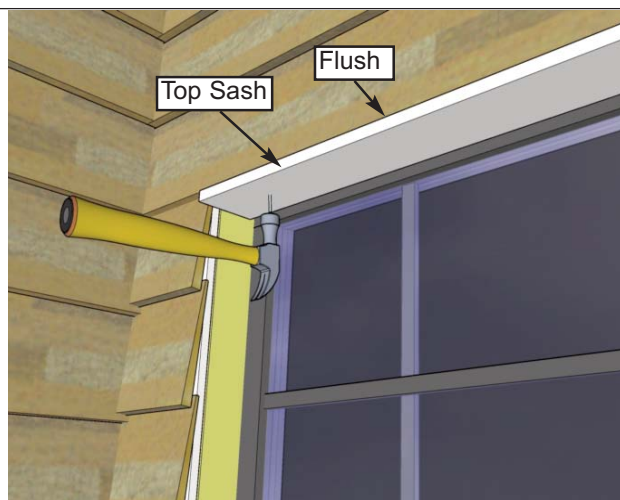
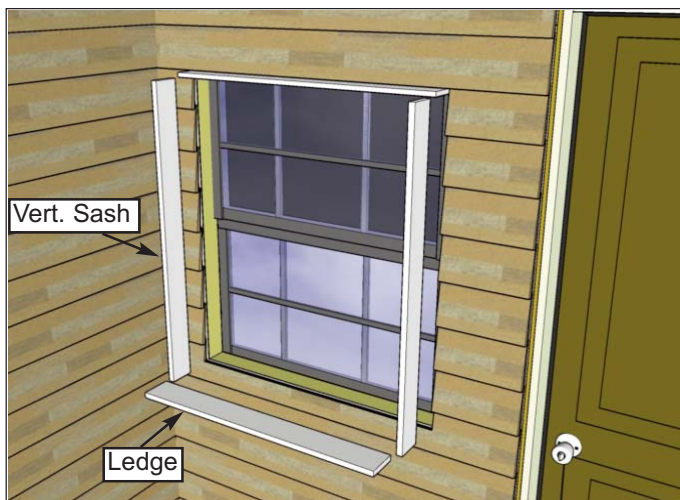

20. Locate Top, Vertical and Ledge Sash pieces. Starting with Top Sash, position in window cavity framing. Attach with **6 - 1 1/2" Finishing Nails**.

Parts (Steps 20 - 21)
3A - Straight Cut Top Sash
 (1/2" x 2 7/8" x 35 7/8") x 1 /window
3B - Straight Cut Vertical Sash
 (5/8" x 2 7/8" x 35 3/8") x 2 /window
3C - Straight Cut Ledge
 (5/8" x 3 3/8" x 29 1/8") x 1 /window

Hardware (Steps 20 - 21)
N1 - 1 1/2" Finishing Nails
 x 48 total

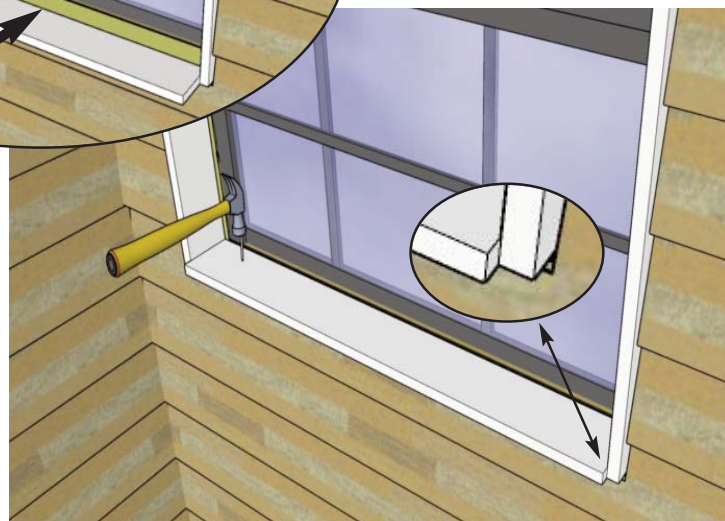
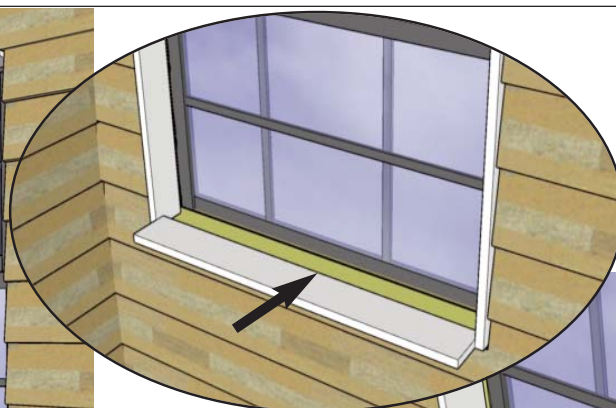

21. Position and attach both Straight Cut Vertical Sash pieces in cavity with **6 - 1 1/2" Finishing Nails** per piece. Finally, position ledge between vertical sash pieces and attach with **6 - 1 1/2" Finishing Nails**. Ledge will protrude out past the vertical sash slightly. Complete sash pieces for 2nd large window.



22. Locate Top and Bottom Transom Sash pieces. Starting with Top Sash, position in window cavity framing. Attach with **6 - 1 1/2" Finishing Nails**.

Parts (Steps 22 - 23)

3D - Straight Cut Top/Bottom Sash
 (1/2" x 2 7/8" x 35 1/4") x 2 /window
3E - Straight Cut Side Sash
 (1/2" x 2 7/8" x 9 1/4") x 2 /window

Hardware (Steps 22 - 23)

N1 - 1 1/2" Finishing Nails
 x 54 total

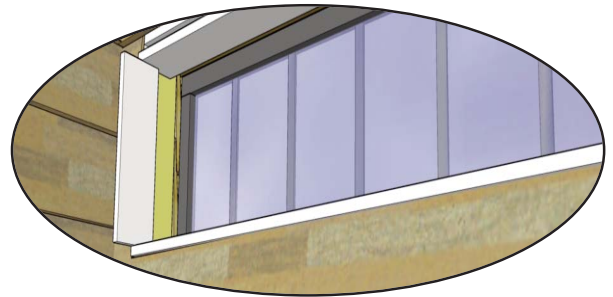
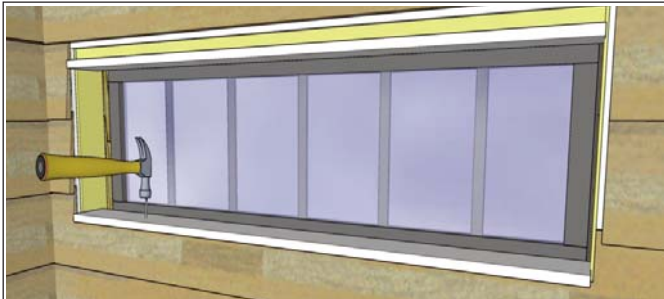

23. Complete attachments of bottom and side sash pieces in transom window cavities. Use **3 - 1 1/2" Finishing Nails** for side sash pieces. Make sure sash pieces do not protrude past siding as trim will cover sash and needs a flat surface to attach to.

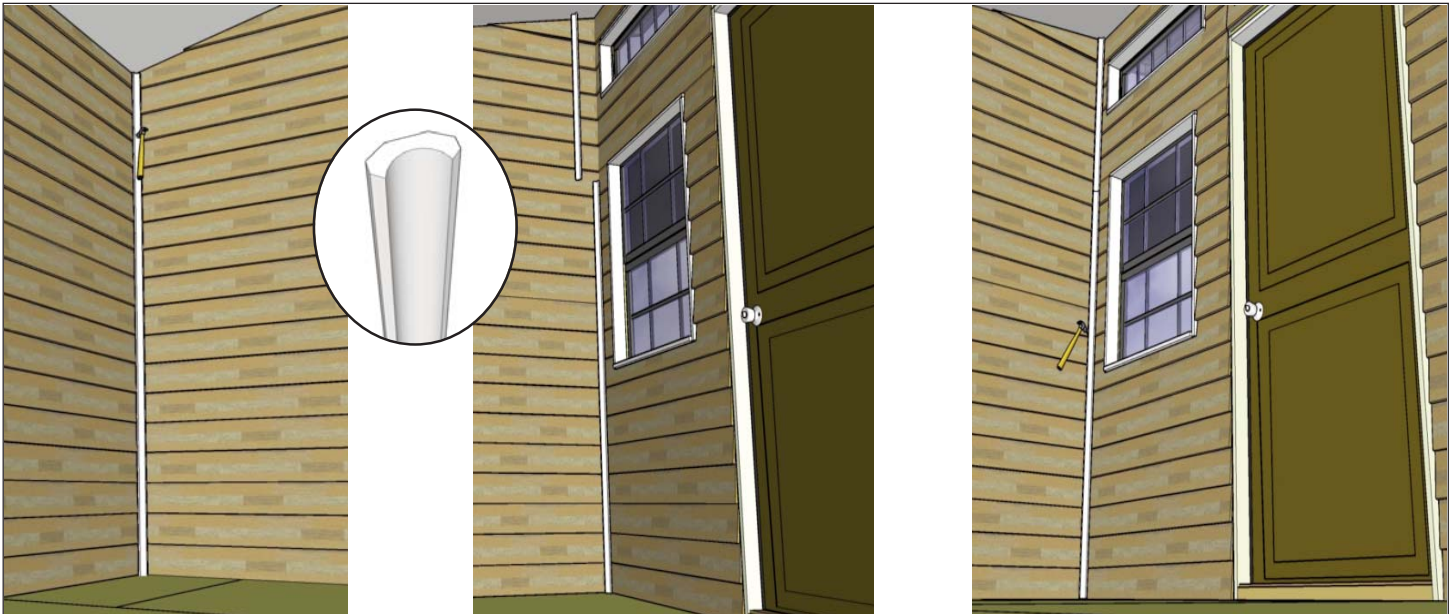

24. Locate all Corner Rounded Trims. Rear Corner Tops are angle cut 11 deg. Attach in corner with **8 - 1 1/2" Finishing Nails**. Front Corners use 2 peices (70" & 32" with 11 deg. cut top). Attach with **10 - 1 1/2" Finishing Nails**.

Parts

- 3F - Rear Corner Rounded Trim**
(85 3/8" with 11 deg. one end) x 2
- 3G - Front Corner Rounded Trim**
(70" Straight Cut) x 2
- 3H - Front Corner Rounded Trim**
(32" with 11 deg.cut one end) x 2

Hardware

- N1 - 1 1/2" Finishing Nails**
x 36 total

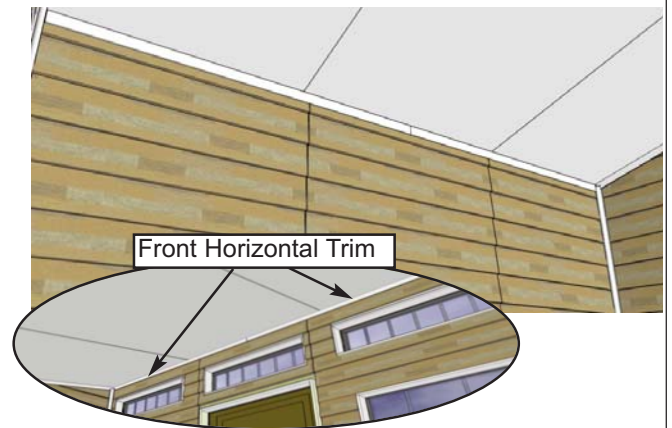
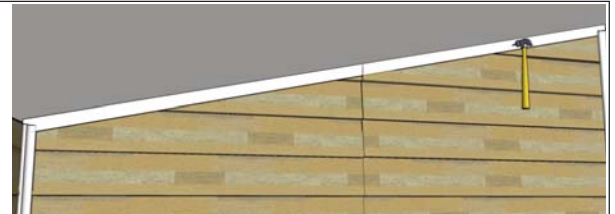
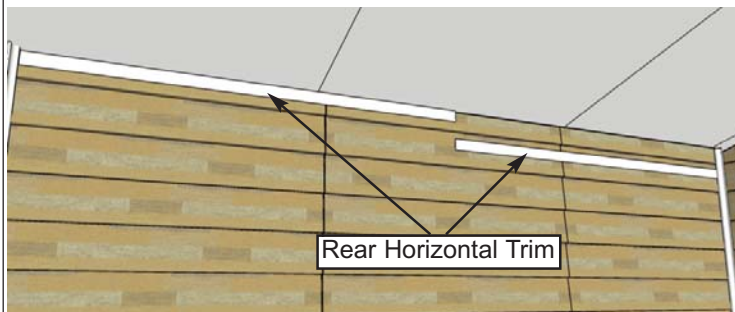
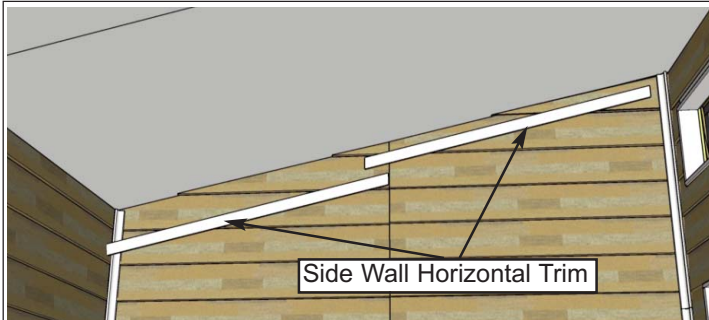

25. Locate all Horizontal Wall Trim. Starting with sides, attach against plywood ceiling and wall. with **6 - 1 1/2" Finishing Nails**.per piece. Complete Rear and Front Horizontal Trim by attaching with **6 - 1 1/2" Finishing Nails** per piece.

Parts

- 3I - Side Wall HorizontalTrim**
(1/4" x 1 1/2" x 45 1/2" - 11 deg ends) x 2
- 3J - Side Wall HorizontalTrim**
(1/4" x 1 1/2" x 44 3/8" - 11 deg ends) x 2
- 3K - Front/Rear Wall Hor.Trim**
(1/4" x 1 1/2" x 64" - Straight Cut) x 4

Hardware

- N1 - 1 1/2" Finishing Nails**
x 48 total

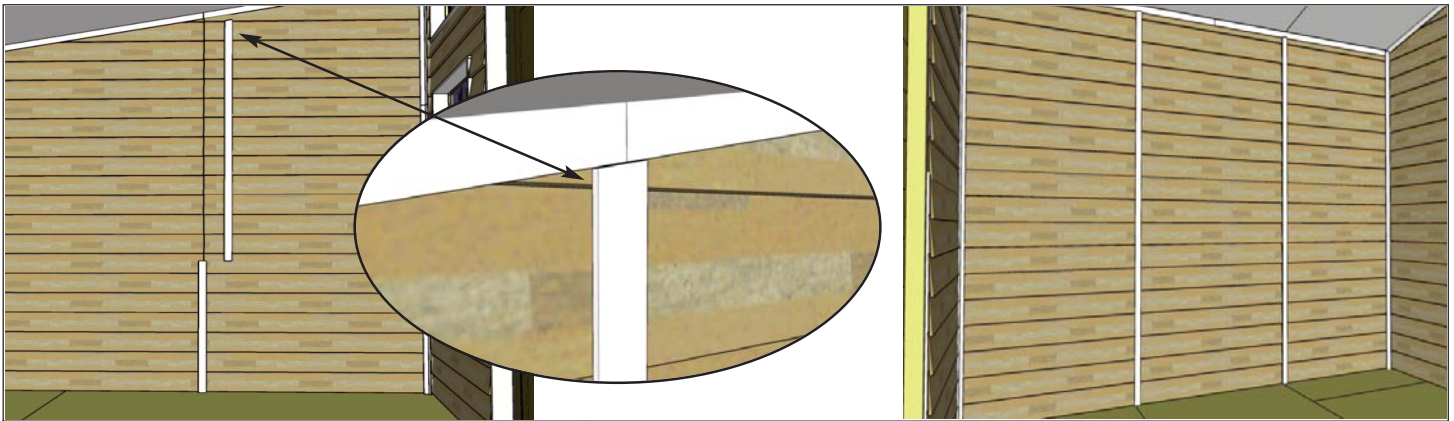

26. Locate all Vertical Wall Trims. Attach 60" long side trim (3L) with 11 deg angle cut end and then short (3M) trim on wall seam with **10 - 1 1/2" Finishing Nails**. Attach Rear Wall Trim on wall seams with **8 - 1 1/2" Finishing Nails** per trim.

Parts

- 3L - Side Wall Vertical Trim**
(1/4" x 1 1/2" x 60"-11 deg. end) x 2
- 3M - Side Wall Vertical Trim**
(1/4" x 1 1/2" x 32" -Straight Cut) x 2
- 3N - Rear Wall Vertical Trim**
(1/4" x 1 1/2" x 83 1/2"-Straight Cut) x 2

Hardware

- N1 - 1 1/2" Finishing Nails**
x 36 total

27. Position Vertical and Horizontal Door Trims lining up the 45 deg. cut ends. When in correct location, attach with **20 - 1 1/2" Finishing Nails**. Do a dry run before attaching.

Parts

- 30 - Vertical Door Trims**
(1/2" x 2 1/2" x 80 3/4" - 45 deg. one end) x 2
- 3P - Horizontal Door Trim**
(1/2" x 2 1/2" x 41" - 45 deg. both ends) x 1

Hardware

- N1 - 1 1/2" Finishing Nails**
x 20 total

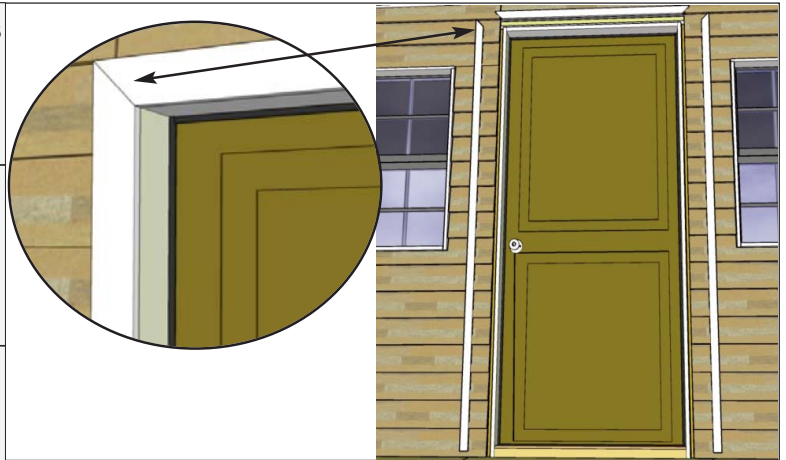

28. Position Vertical and Horizontal Window Trims lining up the 45 deg. cut ends. When in correct location, attach with **15 - 1 1/2" Finishing Nails**. Do a dry run before attaching.

Parts

- 3Q - Vertical Large Window Trims**
(1/2" x 1 1/2" x 36 7/8" - 45 deg.1 end) x 2 /window
- 3R - Horizontal Window Trim**
(1/2" x 1 1/2" x 32 1/4" - 45 deg both ends) x 1 /window

Hardware

- N1 - 1 1/2" Finishing Nails** x 30 total

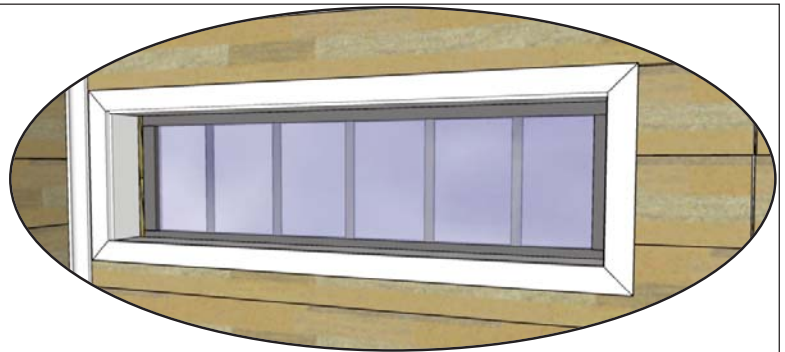

29. Position Top/Bottom and Side Window Trims lining up the 45 deg. cut ends. When in correct location, attach with **18 - 1 1/2" Finishing Nails**. Do a dry run before attaching. Complete left/right windows.

Parts
3S - Top/Bottom Transom Window Trims
 (1/2" x 1 1/2" x 37 1/2" - 45 deg. ends) x 4
3T - Side Transom Window Trims
 (1/2" x 1 1/2" x 12 1/2" - 45 deg. ends) x 4

Hardware
N1 - 1 1/2" Finishing Nails
 x 36 total

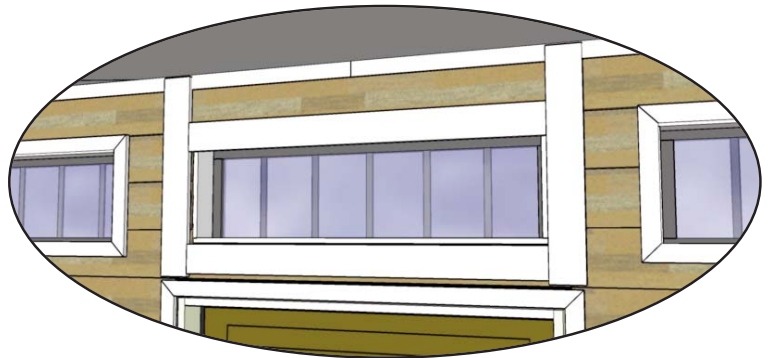

30. Position Top/Bottom and Side Trims around center transom window. When in correct location, attach with **16 - 1 1/2" Finishing Nails**. Do a dry run before attaching.

Parts
3U - Top/Bot. Transom Window Trims - (C)
 (1/2" x 1 1/2" x 34 1/2" Straight cut ends) x 2
3V - Side Transom Window Trims - (C)
 (1/2" x 3" x 20" - Straight cut ends) x 2

Hardware
N1 - 1 1/2" Finishing Nails
 x 16 total

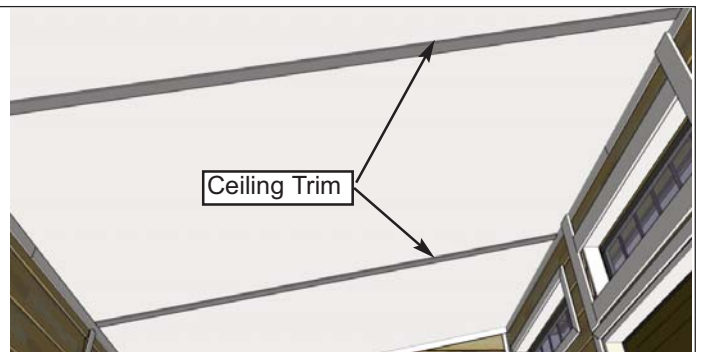
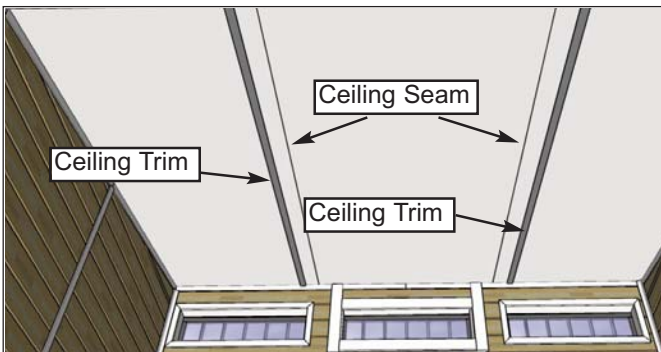

31. Position Ceiling Trim over plywood ceiling seam. When in correct location, attach with **8 - 1 1/2" Finishing Nails** per piece.

Parts
3W - Ceiling Trims
 (1/4" x 1 1/2" x 92 1/4" -Straight cut) x 2

Hardware
N1 - 1 1/2" Finishing Nails
 x 16 total

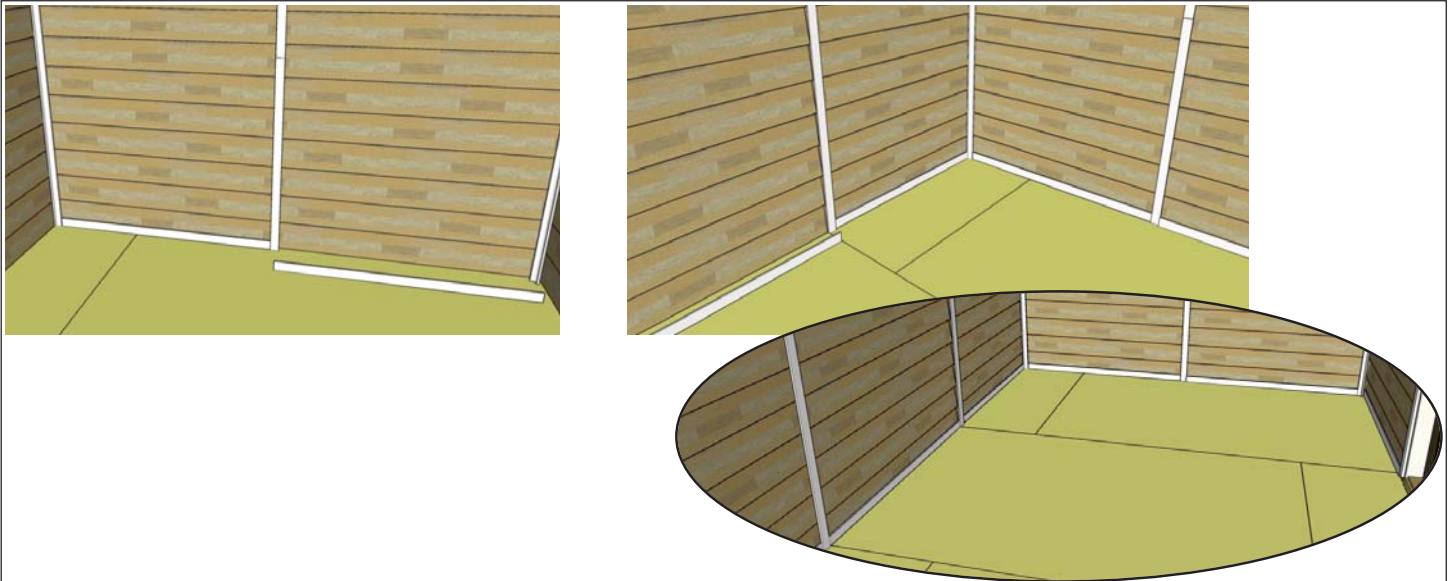

32. Place 1st Floor Base Trim between Vertical Wall Trim. Measure trim and cut to correct length. Attach with **4 - 1 1/2" Finishing Nails**. Complete remaining Floor Base Trims measuring and cutting each piece.

Parts
3X - Floor Base Trims
 (1/4" x 1 1/2" x 48" - Straight cut
 - (customer to cut to length) x 9

Hardware
N1 - 1 1/2" Finishing Nails
 x 36 total



Congratulations on assembling your 12x8 Studio Garden Shed Interior Wall Kit!

We value your feedback and would like to hear back from you on how well we are doing in the following areas:

- 1. Customer Service**
- 2. On Time Shipping**
- 3. Motor Freight Delivery**
- 4. Quality of Materials**
- 5. Assembly Manual**
- 6. Overall Satisfaction.**

Please call, write or email us at:

Outdoor Living Today

Canadian Address
 9393 287th Street
 Maple Ridge, British Columbia
 Canada V2W 1L1

United States Address
 P.O. Box 96
 Sumas, Washington
 USA 98295

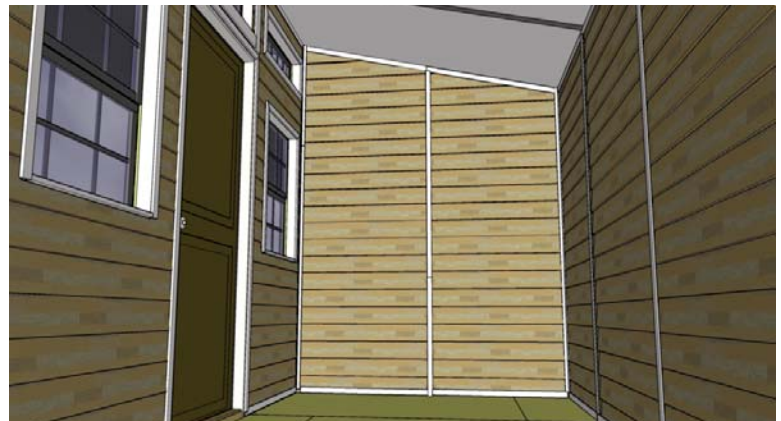

The materials contained in this Assembly Manual may be downloaded or copied provided that ALL copies retain the copyright and any other proprietary notices contained on the materials. No material may be modified, edited or taken out of context such that its use creates a false or misleading statement or impression as to the positions, statements or actions.