



Revision #1.0
March 30, 2020

8'X16' Garden in a Box Deer Fence Option Kit Item# RB816DFO

Licensed under US Patents 7,424,787; 7,490,435

Thank you for purchasing a 8' x 16'
Raised Garden Bed Deer Fence
Option Kit.

Please take the time to identify all
the parts prior to assembly.

Please use Safety Eyewear and Gloves
while Assembling. Be sure to read and
follow all operating instructions for any
tools used during assembly.
Remember- NO SAW CUTTING IS
REQUIRED!

Safety Points and Other Considerations
Please follow this instruction manual when
assembling your Raised Garden Bed Deer
Fence Option Kit and retain the manual for
future maintenance purposes.



Deer Fence Height

**Estimated Assembly Time for
the Deer Fence Kit = 1 Hour.**



Safety Equipment Required

(Not Provided)



Safety Glasses



Work Gloves

In the event of a missing or broken piece, simply call the Outdoor Living Today Customer Support Line @ 1-888-658-1658 within 30 days of the delivery of your purchase. It is our commitment to you to courier replacement parts, free of charge, within 10 business days of this notification. Replacement parts will not be provided free of charge after the 30 day grace period.

Exploded View and Parts List for 8x16 Raised Bed Deer Fence Option Kit

Parts List

- Part 1** 10 pcs - Side/Rear Deer Fence Panels (46"wide x 33 1/2"high)
- Part 2** 3 pcs - Front Deer Fence Panels (30 5/8"wide x 33 1/2"high)
- Part 3** 2 pcs - Black Plastic Butt Hinge
- Part 4** 4 pcs - Corner Brackets (angle cut ends) (1 1/2" x 1 1/2" x 24")
- Part 5** 7 pcs - Vertical Panel Supports - Long (3/4" x 2 1/2" x 45")
- Part 6** 7 pcs - Vertical Panel Supports - Short (3/4" x 2 1/2" x 22")

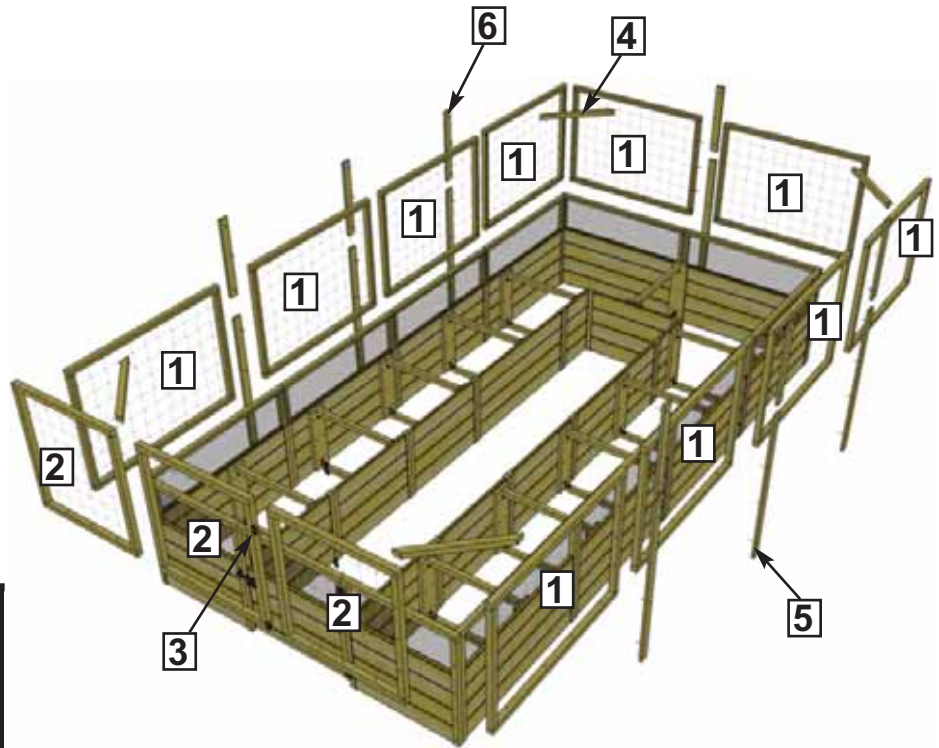

Hardware Kit (Provided)



#2 Square Drive Bit x 1 pc



2 1/2" 118 pcs



2" 42 pcs



Black 12 pcs



Black Plastic Butt Hinge - 2 pcs

Tools Required (Not Provided)



Screw Gun/Drill



1/8" Drill Bit



Level



Tape Measure



Wood Clamp



Hammer

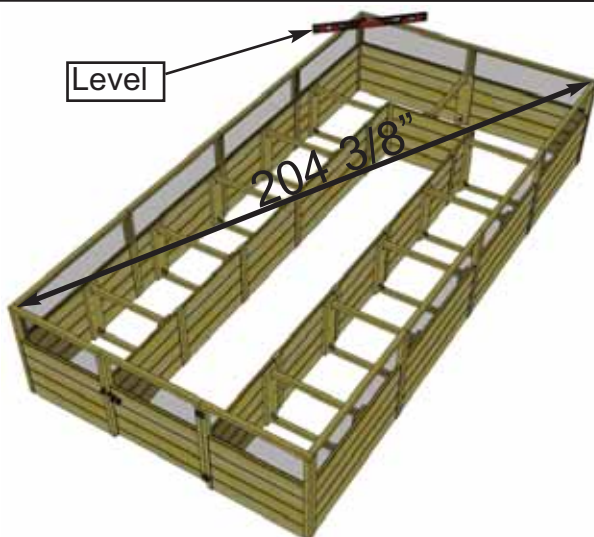

Important - Back Wall Trellis Screens, if installed on the regular 8x16 Raised Bed will need to be removed to install the Deer Fence Option Kit.

1. Prior to installing your Deer Fence Option Kit, confirm your 8x16 Raised Bed is level and square. Measure diagonally inside corner to corner (approximately 204 3/8") in both directions. Adjust as required. Use a level to determine if the tops of the bed frames are sloped and adjust if necessary.

We recommend filling your raised bed with soil prior to installing your Deer Fence Option Kit.

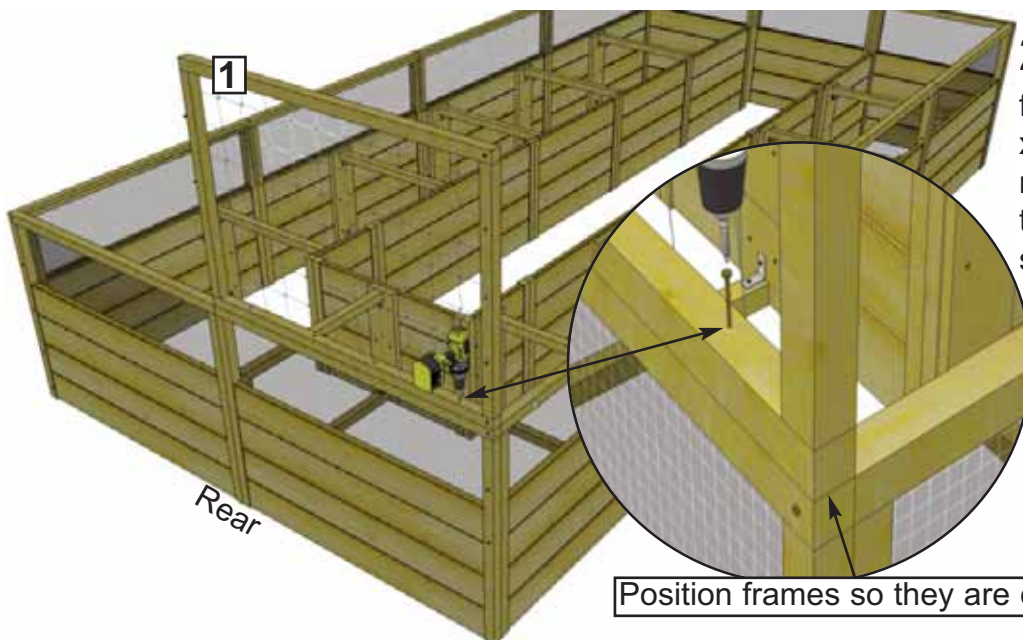

2. Starting in rear corner, position the frame of a **Rear Panel (1) - 46" wide x 33 1/2" high** directly on top of the raised bed frame. Screw frames together with **4 - 2 1/2" screws** as shown on the left.

Expert Advise:
Use a Wood Clamp when positioning and attaching deer fence panels together.

Position frames so they are even.

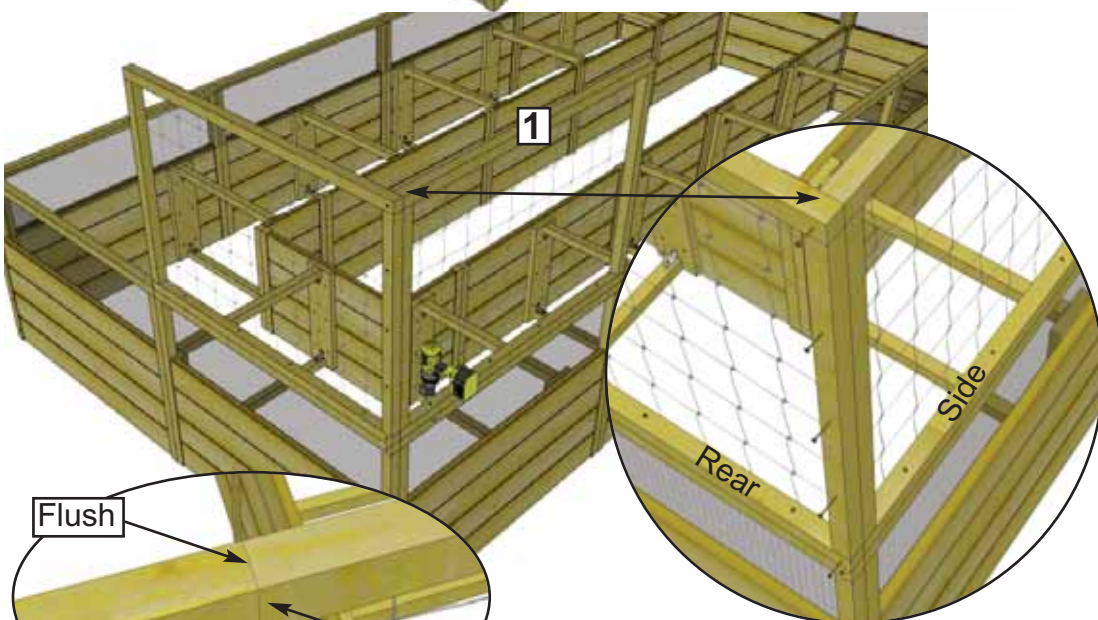

3. Position a **Side Panel (1) - 46" wide x 33 1/2" high** directly on top of the side raised bed frame. Hold both deer fence frames together and starting at the top, screw together with **5 - 2 1/2" screws** as shown on the left. Screw bottom of frame down to raised bed frame with **4 - 2 1/2" screws**.

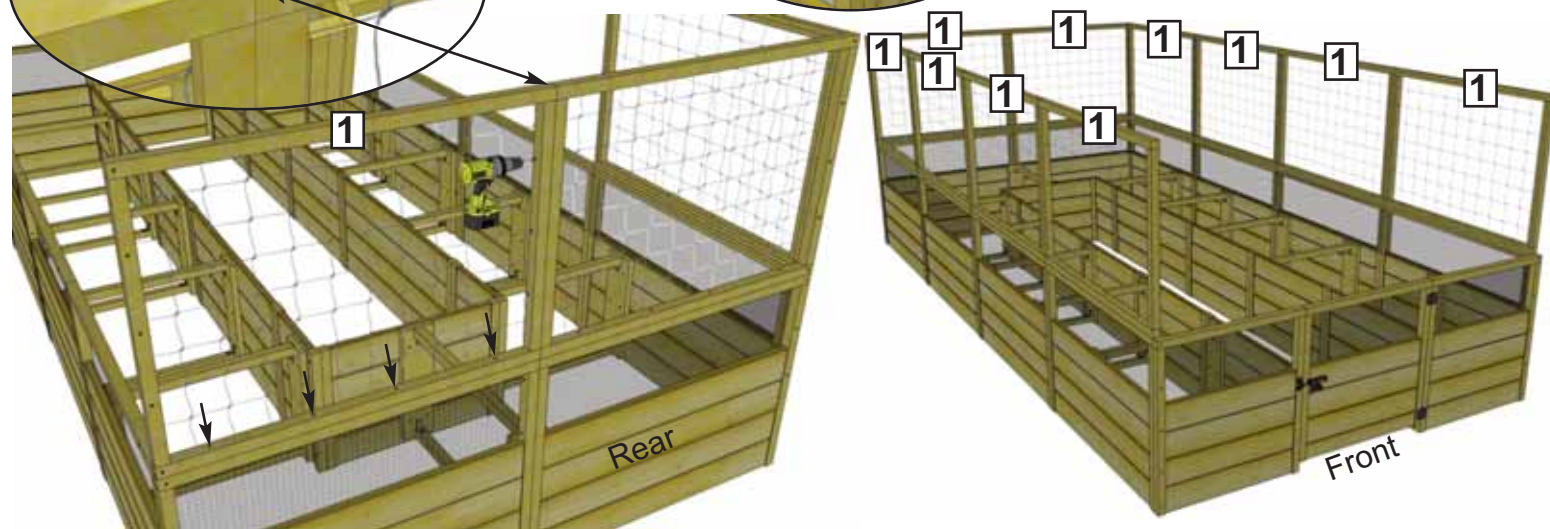
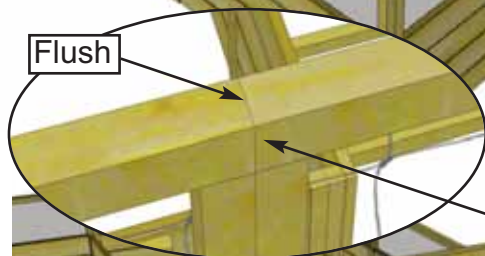

4. Position a second **Rear Panel (1) - 46" wide x 33 1/2" high** on top of the rear raised bed frame. Hold both rear deer fence frames together and starting at the top, screw together with **4 - 2 1/2" screws** as shown above. Screw bottom of frame down to raised bed frame with **4 - 2 1/2" screws**. Complete remaining side and rear panels attachments following **Steps 2 and 3**.



5. Locate all three **Front Deer Fence Panels (2)** - 30 5/8" wide x 33 1/2" high. Designate one to be a door panel and leave to the side. Attach both outside panels as per **Steps 1 - 3** except use only **3 - 2 1/2" screws** to attach bottom frame. Position and install designated door panel between front panels and screw only from bottom frame into top of raised bed door frame with **3 - 2 1/2" screws** as shown above.

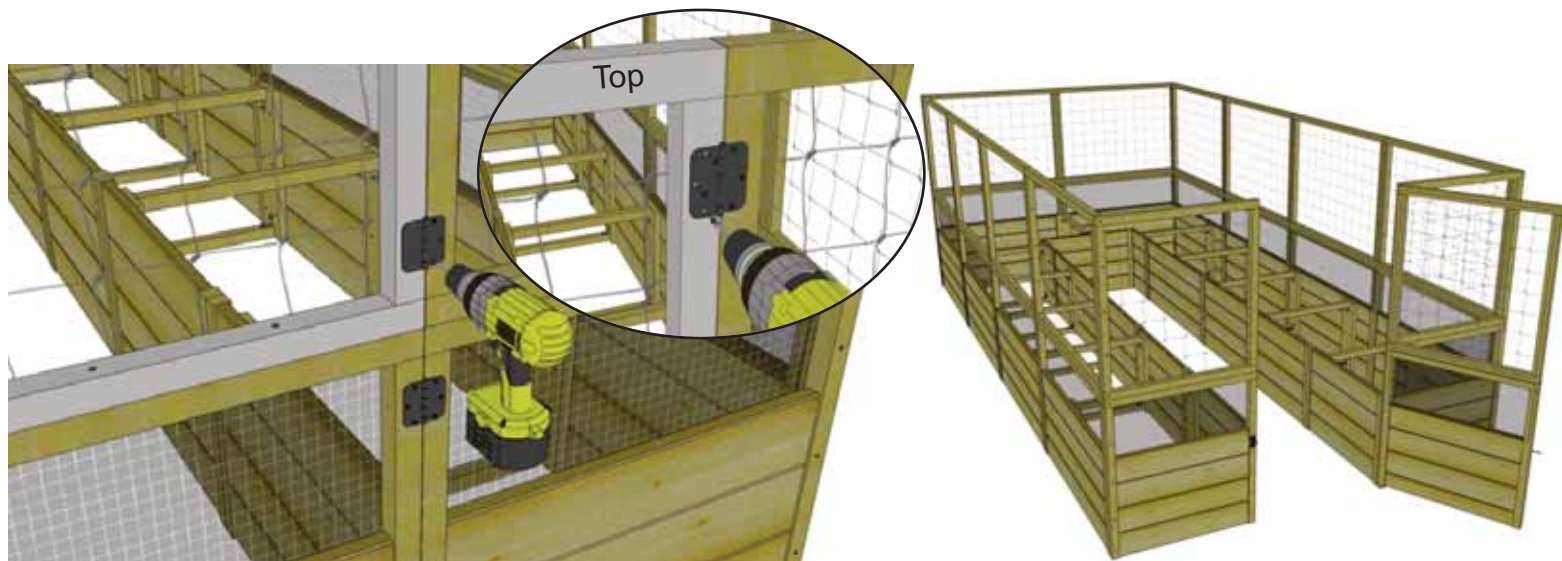

6. Locate both **Black Plastic Hinges (3)** and attach to deer fence frame with **6 - 3/4" black screws** per **hinge** as shown above. Use 1/8" drill bit to pilot hole shallow holes before attaching to avoid splitting deer fence framing. Open and close door to check door aligned correctly. Adjust as required.

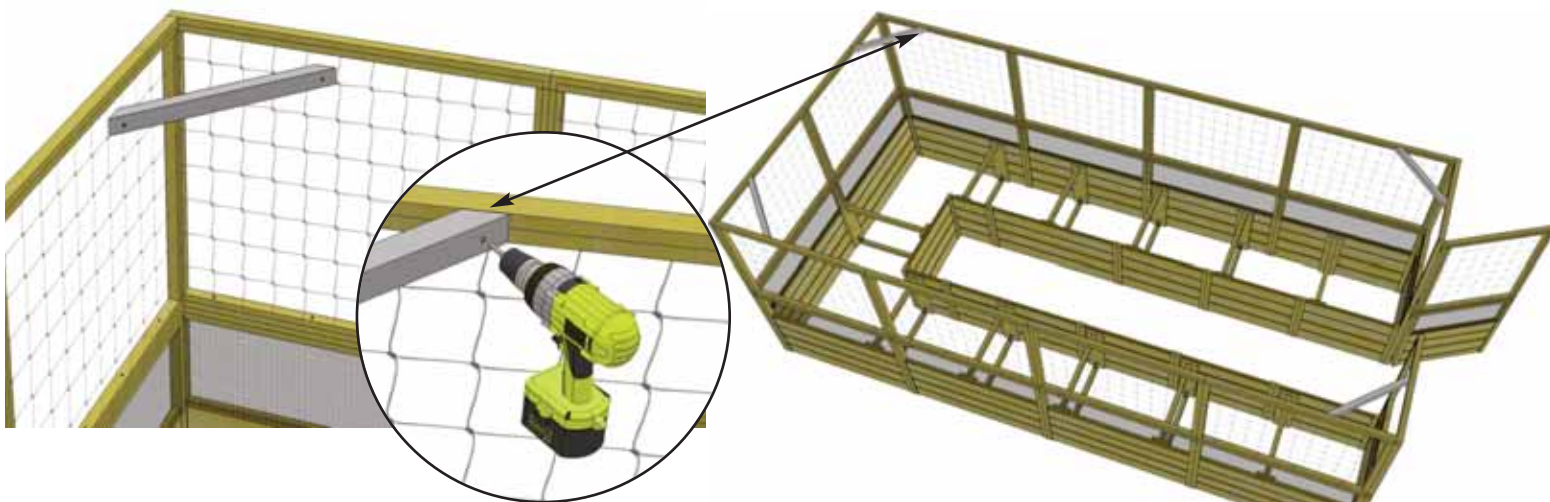

7. Attach **Corner Brackets with angle cut ends - (4)** on the inside frames at the top. Use **2 - 2 1/2" screws** per bracket. Screw on an angle. Pre-drill ends with 1/8" drill bit to prevent wood splitting.

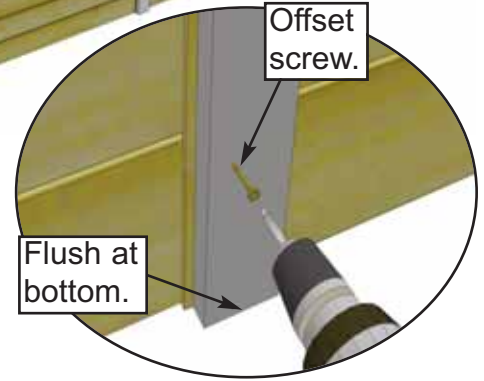
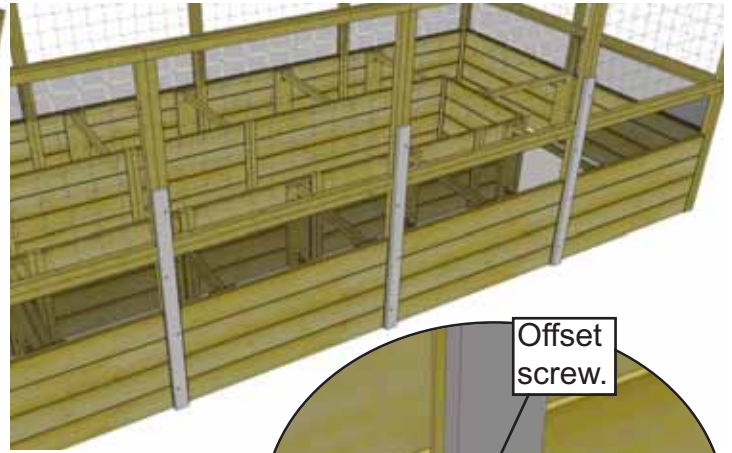
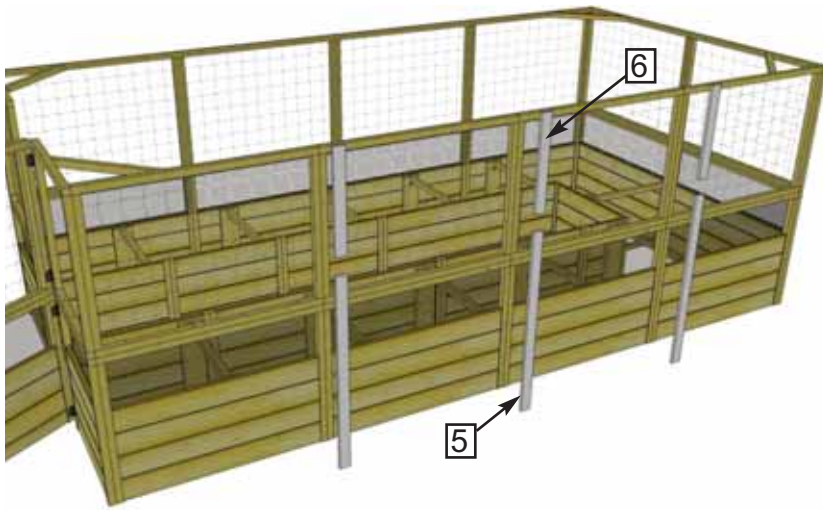

8. Locate **Vertical Panel Supports - Long (5) - 3/4" x 2 1/2" x 45"** and **Vertical Panel Supports - Short (6) - 3/4" x 2 1/2" x 22"**. Starting with 45" long support first, center on panel frames, flush at bottom and attach with **4 - 2" screws**. Offset the screw to either side of the support to ensure you contact the heart of the bed frame.

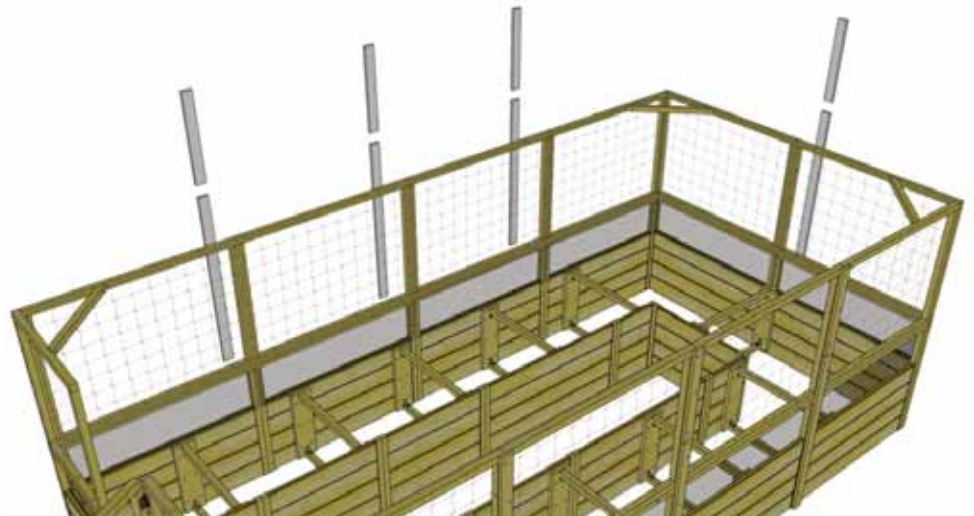
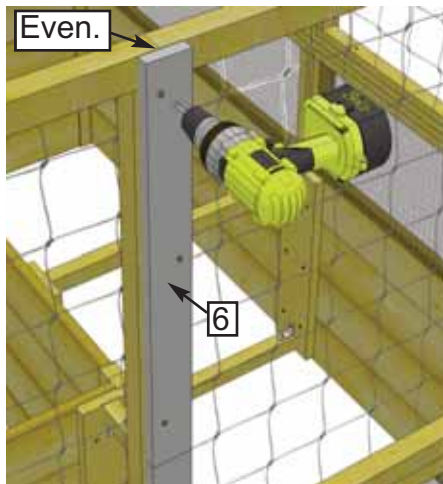

9. Position and attach short Vertical Panel Support using **3 - 2" screws** as per **Step 8**. Complete remaining rear and side walls.

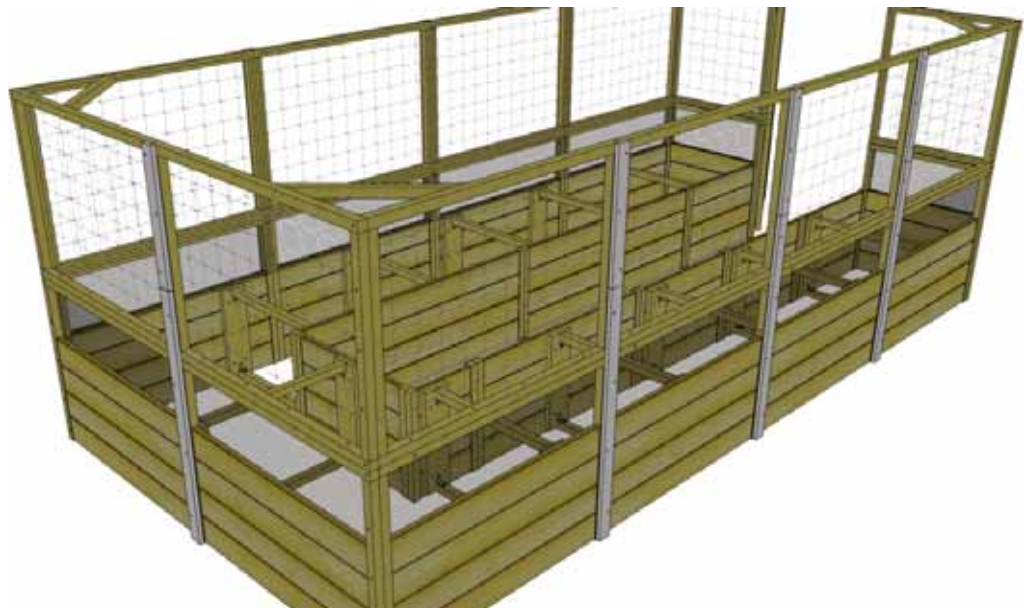

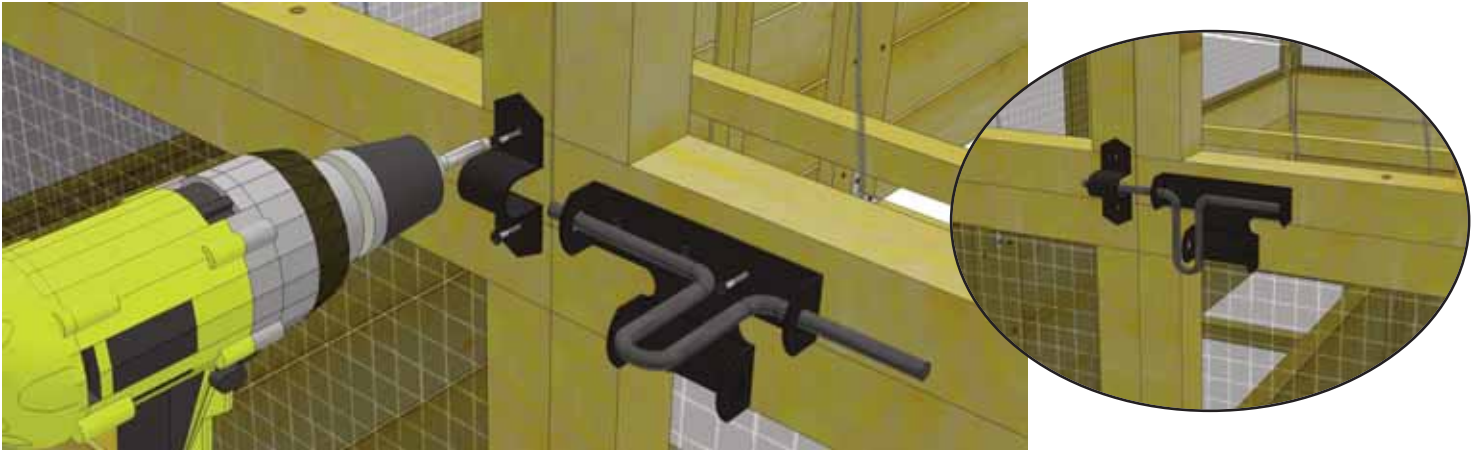

10. Attach Black Barrel Bolt to door and panel frame using **6 - 3/4" black screws**. Note how female part of Barrel Bolt is positioned higher than male. Do a dry run first to position Barrel Bolt correctly, then attach. Pre-drill with 1/8" drill bit to prevent wood from splitting.

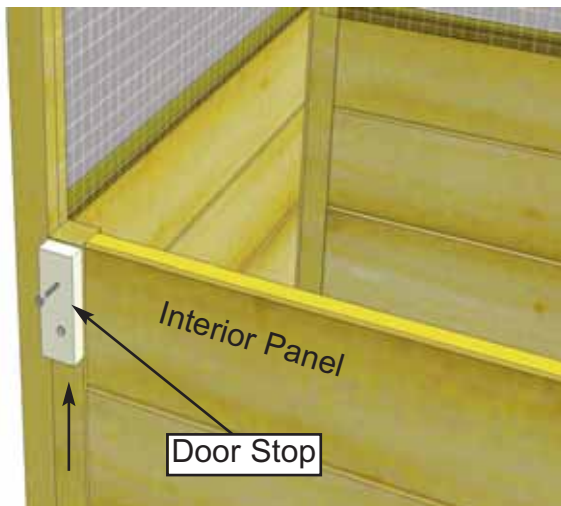

11. The **Door Stop (I)** and screws were included with your 8x16 Raised Garden Bed Kit. See **Step 21** of that manual. Install the Door Stop at the top of interior panel frame as shown above.

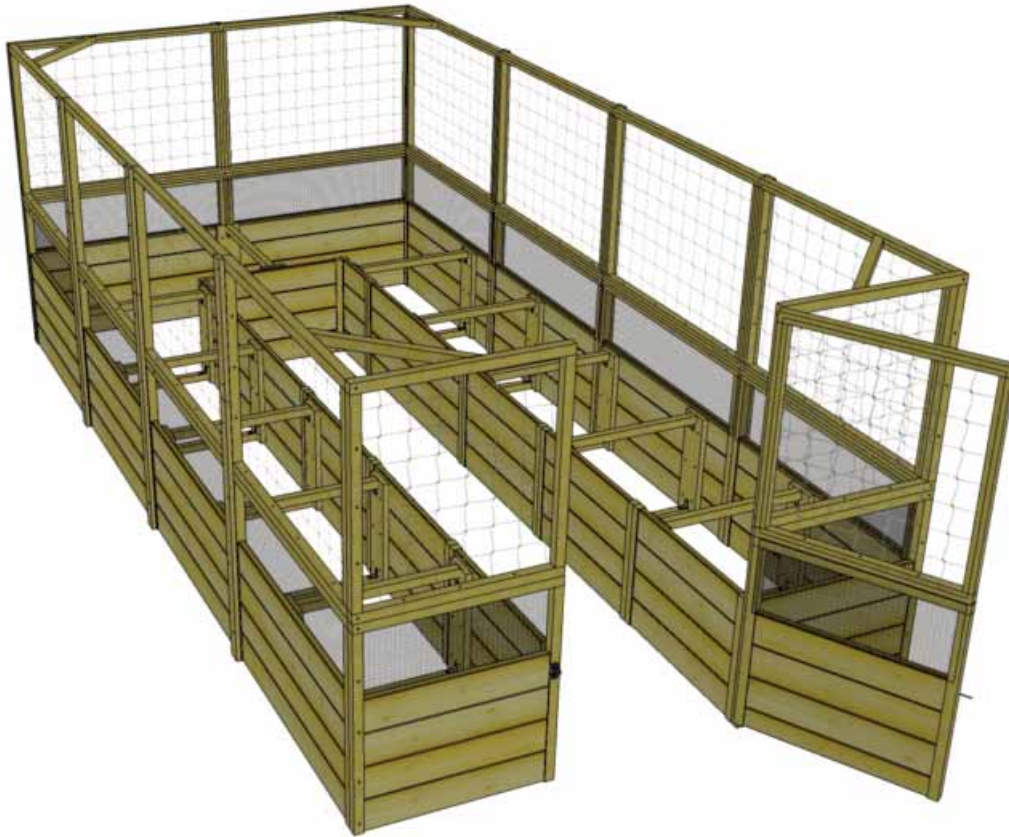

We hope your experience assembling our **8'x16' Raised Garden Bed Deer Fence Option Kit** has been both positive and rewarding. We value your feedback and would like to hear back from you on how well we are doing in the following areas:

- 1. Customer Service**
- 2. On Time Shipping**
- 3. Motor Freight Delivery**
- 4. Quality of Materials**
- 5. Assembly Manual**
- 6. Overall Satisfaction.**



The materials contained in this Assembly Manual may be downloaded or copied provided that ALL copies retain the copyright and any other proprietary notices contained on the materials. No material may be modified, edited or taken out of context such that its use creates a false or misleading statement or impression as to the positions, statements or actions.

Please call, write or email us at:

Canadian Address
9393 287th Street
Maple Ridge, British Columbia
Canada V2W 1L1

United States Address
P.O. Box 96
Sumas, Washington
USA 98295